

Systemschnitt

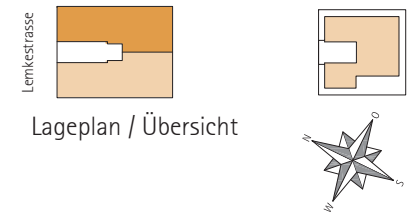

Lageplan / Übersicht

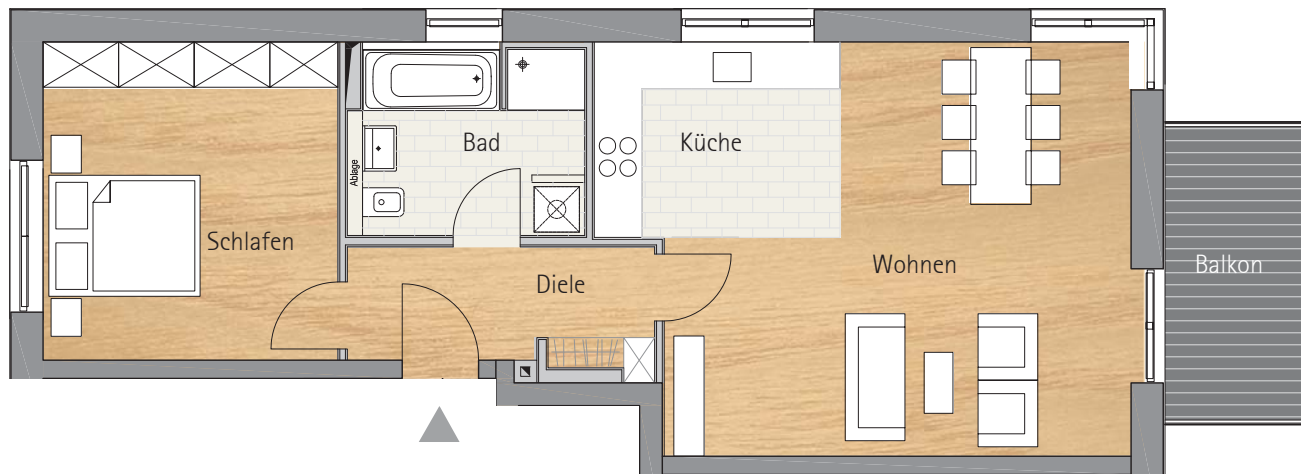

## Wohnung 5

Haus 1 / 2. Obergeschoss / 2 Zimmer

|            |                     |
|------------|---------------------|
| Diele      | 6,28m <sup>2</sup>  |
| Schlafen   | 16,42m <sup>2</sup> |
| Bad        | 7,66m <sup>2</sup>  |
| Küche      | 8,40m <sup>2</sup>  |
| Wohnen     | 28,13m <sup>2</sup> |
| Balkon 50% | 3,54m <sup>2</sup>  |

Gesamt 70,43m<sup>2</sup>

Balkon 100% = 7,08m<sup>2</sup>